

# SPWC

\*Under development

Elbow 90° Connector

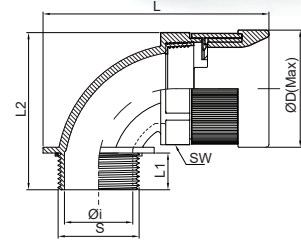

(Unit : mm)

## Specifications

Material	High Quality Polyamide 6	Degrees of Protection	IP 68 (EN 60529)
The max. Instantaneous Temperature	-40 °C to +105°C	Short Term	up to +150° C
Self-Extinguishing	UL94-HB / Free of Halogen Phosphorous and cadmium	Color	Black & Gray
Application	Tramway Vehicle Construction etc.		

	Ordering No.		Thread	Tube Size	S	L1	L2	L	Øi	ØD	SW
	Black	Gray									
Pg Thread (DIN 40430)	SPWC-P077B	SPWC-P077G	Pg07	07	12.5	12.0	37.8	47.0	6.0	18.0	14.0
	SPWC-P09B	SPWC-P09G	Pg09	10	15.2	14.0	51.5	66.4	10.0	24.9	19.7
	SPWC-P11B	SPWC-P11G	Pg11	12	18.6	14.0	51.4	64.7	14.0	27.6	22.8
	SPWC-P136B	SPWC-P136G	Pg13.5	16	20.4	14.0	56.7	70.3	15.0	33.0	28.0
	SPWC-P16B	SPWC-P16G	Pg16	16	22.5	14.0	56.7	70.6	15.2	33.0	28.0
	SPWC-P21B	SPWC-P21G	Pg21	22	28.3	16.0	67.4	87.5	22.0	43.0	37.5
	SPWC-P29B	SPWC-P29G	Pg29	28	37.0	16.0	77.0	105.0	30.5	48.8	43.0
	SPWC-P36B	SPWC-P36G	Pg36	36	47.0	20.0	97.8	130.5	36.0	60.6	52.2
	SPWC-P48B	SPWC-P48G	Pg48	48	59.3	20.0	110.0	147.5	52.4	71.8	64.0
	Metric Thread (EN 60423)	SPWC-M107B	SPWC-M107G	M12 X 1.5	07	12.0	12.0	37.6	47.0	7.5	18.0
SPWC-M10B		SPWC-M10G	M12 X 1.5	10	12.0	14.0	51.2	66.4	7.5	24.9	19.7
SPWC-M12B		SPWC-M12G	M16 X 1.5	12	16.0	14.0	51.2	64.9	12.0	27.6	22.8
SPWC-M16B		SPWC-M16G	M20 X 1.5	16	20.0	14.0	56.5	71.6	15.2	33.0	28.0
SPWC-M22B		SPWC-M22G	M25 X 1.5	22	25.0	16.0	67.4	88.2	20.6	43.0	37.5
SPWC-M28B		SPWC-M28G	M32 X 1.5	28	32.0	16.0	77.0	105.1	27.0	48.8	43.0
SPWC-M36B		SPWC-M36 G	M40 X 1.5	36	40.0	20.0	97.5	130.4	33.0	60.6	52.2
SPWC-M48B		SPWC-M48G	M50 X 1.5	48	50.0	20.0	110.1	145.7	42.0	71.8	64.0

# SPAC

\*Under development

Elbow 45° Connector

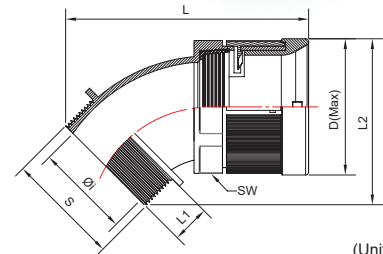

(Unit : mm)

## Specifications

Material	High Quality Polyamide 6 + Brass Nickel plated	Degrees of Protection	IP 68 (EN 60529)
The max. Instantaneous Temperature	-40 °C to +105°C	Short Term	up to +150° C
Self-Extinguishing	UL94-HB / Free of Halogen Phosphorous and cadmium	Color	Black & Gray
Application	Tramway Vehicle Construction etc.		

	Ordering No.		Thread	Tube Size	S	L1	L2	L	Øi	ØD	SW	
	Black	Gray										
Pg Thread (DIN 40430)	SPAC-P09B	SPAC-P09G	Pg09	10	15.2	14.0	32.3	60.6	10.0	24.9	19.7	
	SPAC-P11B	SPAC-P11G	Pg11	12	18.6	14.0	37.2	63.0	14.0	27.6	22.8	
	SPAC-P136B	SPAC-P136G	Pg13.5	16	20.4	14.0	42.1	67.0	15.0	33.0	28.0	
	SPAC-P16B	SPAC-P16G	Pg16	16	22.5	14.0	42.8	68.3	15.2	33.0	28.0	
	SPAC-P21B	SPAC-P21G	Pg21	22	28.3	16.0	52.7	82.7	22.0	43.0	37.5	
	SPAC-P29B	SPAC-P29G	Pg29	28	37.0	16.0	58.8	95.1	30.5	48.8	43.0	
	SPAC-P36B	SPAC-P36G	Pg36	36	47.0	20.0	74.3	115.0	36.0	60.6	52.2	
	SPAC-P48B	SPAC-P48G	Pg48	48	59.3	20.0	85.6	126.9	52.4	71.8	64.0	
	Metric Thread (EN 60423)	SPAC-M10B	SPAC-M10G	M12 X 1.5	10	12.0	14.0	32.5	59.4	7.5	24.9	19.7
		SPAC-M12B	SPAC-M12G	M16 X 1.5	12	16.0	14.0	36.6	62.0	12.0	27.6	22.8
SPAC-M16B		SPAC-M16G	M20 X 1.5	16	20.0	14.0	40.7	67.2	15.2	33.0	28.0	
SPAC-M22B		SPAC-M22G	M25 X 1.5	22	25.0	16.0	51.0	81.0	20.6	43.0	37.5	
SPAC-M28B		SPAC-M28G	M32 X 1.5	28	32.0	16.0	57.3	93.5	27.0	48.8	43.0	
SPAC-M36B		SPAC-M36G	M40 X 1.5	36	40.0	20.0	71.5	112.5	33.0	60.6	52.2	
SPAC-M48B		SPAC-M48G	M50 X 1.5	48	50.0	20.0	82.3	123.5	42.0	71.8	64.0	