

# K16 Accessories

## Protection Covers - Round & Square Type

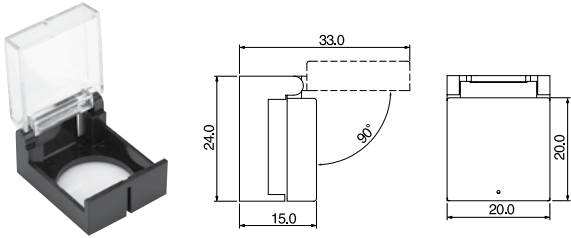

K16-S111 ① : Opens 90 degree

①- Blank: Black, R: Red, G: Green, Y: Yellow

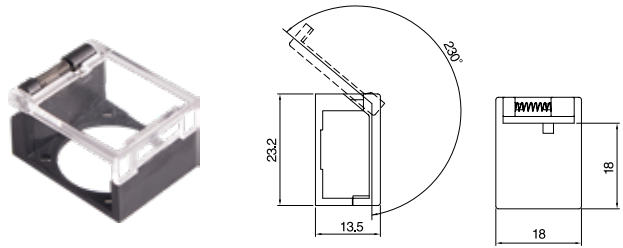

K16-S221 : Opens 230 degree

## Protection Covers - Rectangular Type

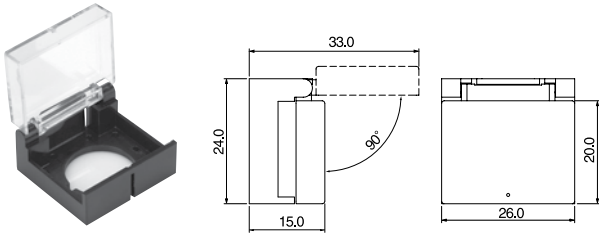

K16-S112 ① : Opens 90 degree

①- Blank: Black, R: Red, G: Green, Y: Yellow

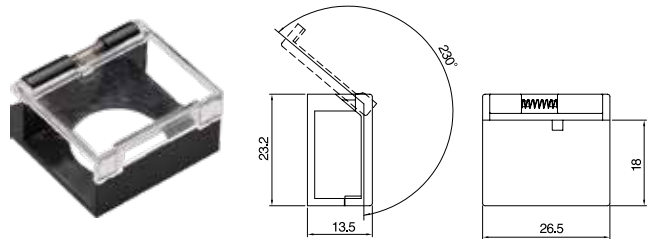

K16-S222 : Opens 230 degree

## Safety Guard

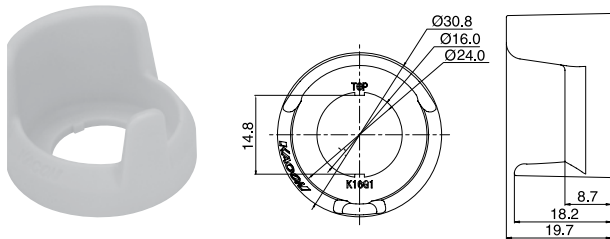

K16-G1

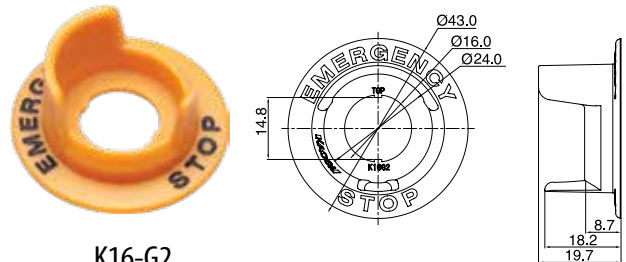

K16-G2

## LED

K16-S115①

① - R, Y, G, B, C & 6, 12, 24VDC



## Transformer

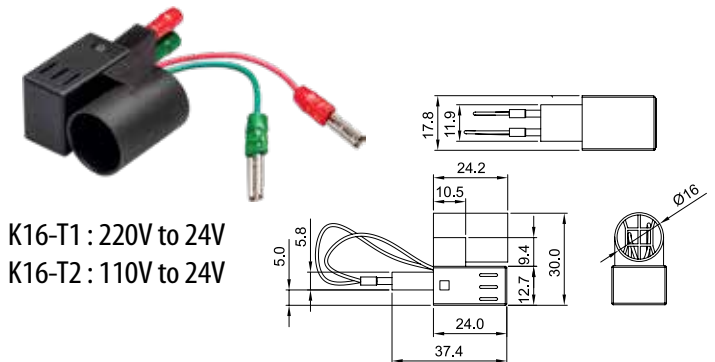

K16-T1 : 220V to 24V  
K16-T2 : 110V to 24V

## Hand Tools

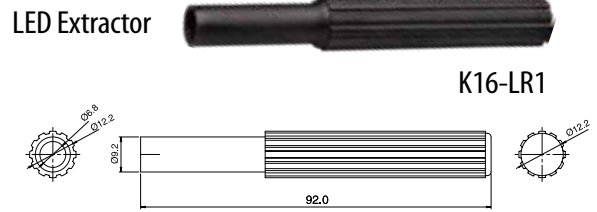
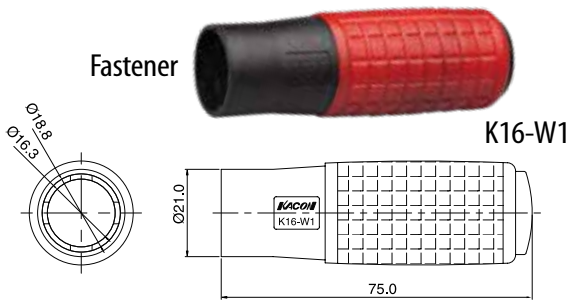

## Sockets

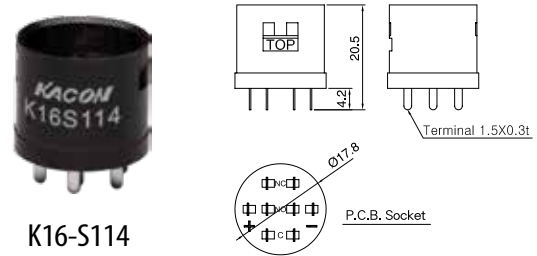
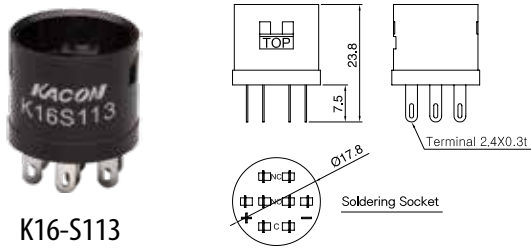

## Terminal Protection



K16-S116

## Protection Cover



K16-S223

## R Type Lens



K16-S224

## Flush Mounting Guard



Switches shown with  
flush mounting guard